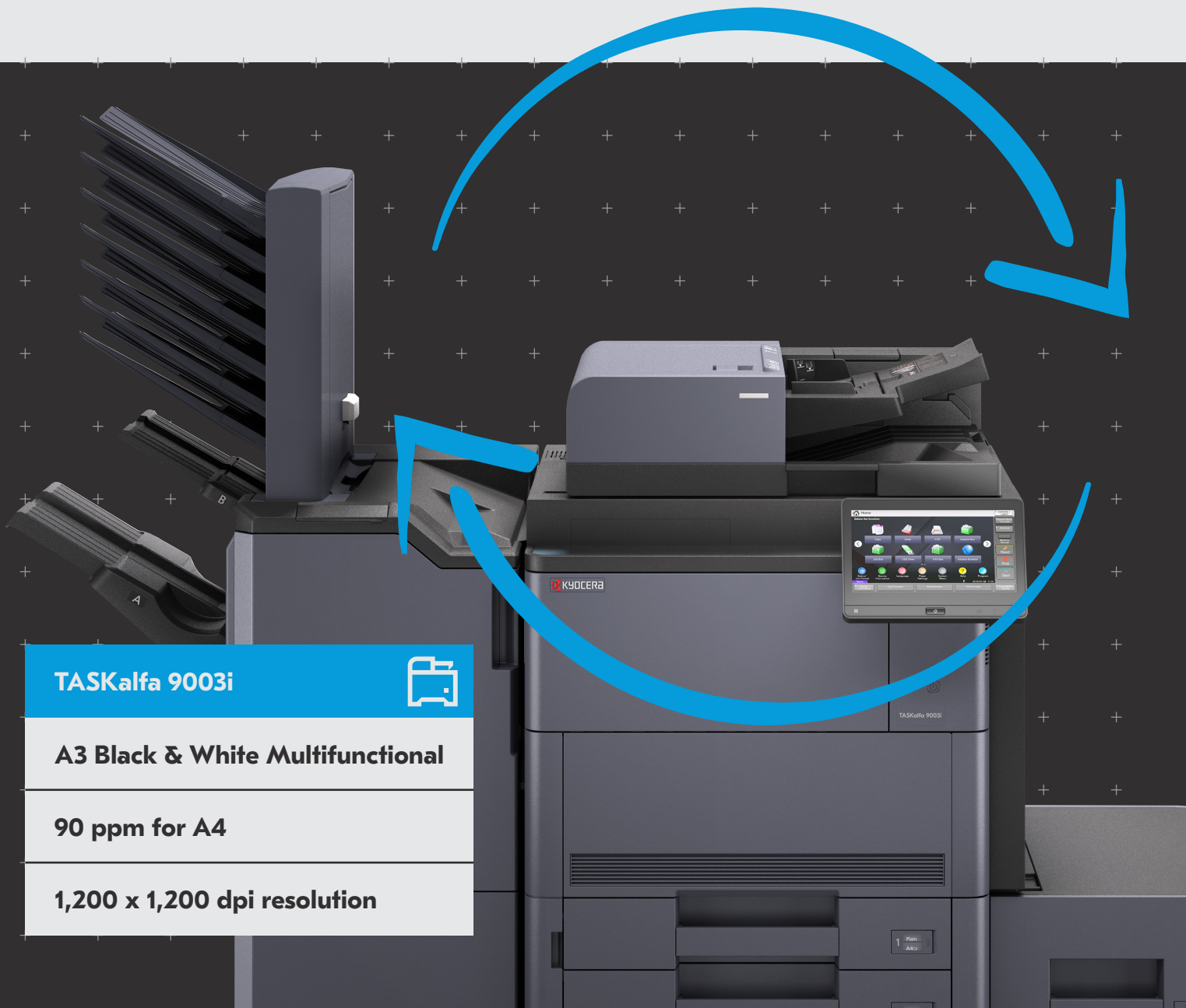

# Stability to help you grow new markets

Designed to operate in demanding high-end work environments and keep up with your ever-changing way of working. These user friendly, secure and productive B/W MFP series – TASKalfa 7003i, 8003i and 9003i – will astonish you. Thanks to its newly designed 10.1" touch panel, accessing all features and getting exactly the results you need, is very intuitive and simple. To keep your data safe these models are equipped with various security features. In addition, the maximum input paper capacity of 7,650 sheets and output paper capacity of 4,300 sheets, is well suited to handle your largest and most complex print jobs.

**TASKalfa 9003i****A3 Black & White Multifunctional****90 ppm for A4****1,200 x 1,200 dpi resolution**

## Specifications

### GENERAL

KYOCERA TASKalfa Laser Black & White Multifunctional, HyPAS™ solution platform  
**Operation panel:** 256.5mm (10.1 inch) full-colour touch panel display, speaker for job notification, 15°–90° swivel mounted  
**Engine speed:** Up to 90 pages A4 per minute, up to 45 pages A3 per minute, Duplex print speed: 90 pages per minute, A4  
**Resolution:** 1,200 × 1,200 dpi (print), 600 × 600 dpi (scan/copy)  
**Warm-up time:** Approx. 30 seconds or less from power on  
**Time to first print:** Approx. 4.0 sec. or less  
**Time to first copy:** Approx. 3.6 sec. or less (DP)  
**CPU:** NXP QorIQ T1024 (Dual Core) 1.4GHz  
**Memory:** Standard 4.5GB, Max. 8GB SSD + 320GB HDD  
**Standard interfaces:** USB 2.0 (Hi-Speed), 4 × USB Host Interface, Gigabit Ethernet (10BaseT/100BaseTX/1000BaseT, IPv6, IPv4, IPSec, 802.3az support), NFC tag, 2 eKUIO slots for optional internal print server or for optional fax system(s), slot for optional SD Card  
**Integrated accounting:** 1,000 department codes  
**Dimensions (W × D × H):** 750mm × 822mm × 1,234mm  
**Weight:** Main unit approx. 150kg  
**Power source:** AC 220–240 V, 50/60Hz  
**Power consumption:** Print mode: 1340W, Copy mode: 1340W, Low power mode: 100W, Ready mode: 110W, Sleep mode: 0.7W  
**Noise (sound pressure level ISO 7779 measurement distance of 1 meter):**  
Copying/Printing: 55 dB(A) L<sub>pA</sub>, Stand by mode: 32.6 dB(A) L<sub>pA</sub>  
**Safety standards:** TÜV/GS, CE. This unit is manufactured according to ISO 9001 quality standard and ISO 14001 environmental standard.

### PAPER HANDLING

All paper capacities quoted are based on paper thickness of max. 0.11mm. Please use paper recommended by Kyocera under normal environmental conditions.  
**Input capacity:** Multi-purpose tray: 150 sheets, 60–300 g/m<sup>2</sup> (Banner 136–165 g/m<sup>2</sup>), A3+, A3, A4, A5, A6, B5, Ledger, Letter, Legal, Folio, Custom (98 × 148 to 297 × 432mm), Banner max. 305 × 1,220mm;  
Standard universal paper cassette: 2 × 500 sheets, 60–256 g/m<sup>2</sup>, A3+, A3, A4, A5, B5, Ledger, Letter, Legal, Folio;  
High-capacity paper deck: 2 × 1,500 sheets, 60–256 g/m<sup>2</sup>, A4, B5.  
Max. input capacity with options: 7,650 sheets A4  
**Document processor:** (one-path duplex scanning) 270 sheets, 35–220 g/m<sup>2</sup> (simplex), 50–220 g/m<sup>2</sup> (duplex), A6R–Banner up to 2,200mm  
**Duplex as standard unit:** 60–256 g/m<sup>2</sup>, A5R–305 × 457mm  
**Output capacity:** Standard job separator tray 70 sheets; optional copy tray (D): upper 100 sheets, lower 250 sheets; max. optional output capacity 4,300 sheets

### PRINT FUNCTIONS

**Controller language:** PRESCRIBE  
**Emulations:** PCL6 (PCL-XL/PCL-5e), KPDL 3 (PostScript 3 compatible), PDF, XPS/OpenXPS, PPML  
**Operating systems:** All current Windows operating systems, MAC OS X Version 10.9 or higher, UNIX, LINUX, as well as other operating systems on request.  
**Fonts/barcodes:** 93 outline fonts (PCL), 136 fonts (KPDL 3), 4 fonts

(Calibri), 4 fonts (Cambria), 1 Bitmap font, 79 Outline fonts  
**Print features:** Encrypted PDF Direct Print, IPP printing, e-mail printing, WSD print, secure printing via SSL, IPsec, SNMPv3, quick copy, proof and hold, private print, job storage and job management functionality  
**Mobile printing support:** AirPrint, Mopria, Google Cloud Print compliant, NFC, Direct Wi-Fi (optional), MyPanel and KYOCERA Mobile Print app for iOS and Android

### COPY FUNCTIONS

**Max. original size:** A3/Ledger  
**Continuous copying:** 1–9999  
**Zoom range:** 25–400% in 1% steps  
**Preset magnification ratios:** 5 Reductions/5 Enlargements  
**Exposure mode:** Auto, manual: 16 steps  
**Image adjustments:** Text + Photo, Photo, Text, Map, Printed document  
**Features:** Scan-once-copy-many, electronic sort, 2in1, 4in1, image repeat, page numbering, cover mode, booklet copy, interrupt copy, form overlay, margin shift, auto cassette change, Skip blank page, ID card copy

### SCAN FUNCTIONS

**Functionality:** Scan-to-email, Scan-to-FTP, Scan-to-SMB 3.0, Scan-to-USB Host, Scan-to-box, Network TWAIN, WSD scan (WIA Driver Network)  
**Scan speed:** (A4, 300 dpi, Dual Scan) 220 images per minute; (A4, 300 dpi, Simplex Scan) 120 images per minute  
**Scan resolution:** 600 × 600 dpi, 400 × 400 dpi, 300 × 300 dpi, 200 × 400 dpi, 200 × 200 dpi, 200 × 100 dpi; 256 greyscales per colour  
**Max. scan size:** A3, Ledger, Banner up to 2,200mm  
**Original recognition:** Text, photo, text + photo, light text/fine line, optimised for OCR  
**File types:** TIFF, PDF, PDF/A, JPEG, Open XPS, Encrypted PDF, High compression PDF, PDF/A-1a/b, PDF/A-2a/b/u, OOXML (OCR)  
**Features:** Colour scan, Auto Colour Select, integrated address book, Active Directory support, encrypted data transfer, multi send (e-mail, fax, SMB/FTP folder, print) at once, Blank page skip, Specified colour removal

### FAX FUNCTIONS (OPTIONAL)

**Compatibility:** ITU-T Super G3  
**Modem speed:** Max. 33.6kbps  
**Transmission time:** Max. 3 seconds (IBIG)  
**Scanning speed:** 2.0 seconds/sheet or less  
**Address book:** 2,000 entries  
**Fax resolution:** Normal: 200 × 100 dpi, Fine: 200 × 200 dpi, Superfine: 200 × 400 dpi, Ultrafine: 400 × 400 dpi, 600 × 600 dpi  
**Maximum original size:** A3, Ledger, Banner up to 1,600mm  
**Compression method:** IBIG, MMR, MR, MH

### CONSUMABLES

Average continuous toner yield in accordance with 6% coverage A4.  
**TK-6725 Toner Kit:** Microfine toner black for 70,000 pages A4  
**WT-861 Waste Toner Bottle:** 600,000 sheets (in accordance with 6% coverage)

**Staples:** SH-12 for DF-7110, SH-10 for BF-730/BF-9100, SH-14 for DF-7130

### OPTIONS

**Fax System 12**  
**Internet Fax Kit (A)** (requires Fax System 12)  
**DT-730(B) Document Table**  
**PF-730(B) Paper feeder:** 2 × 500 sheets, 60–256 g/m<sup>2</sup>; A5R–305 × 457mm, folio  
**PF-740(B) Paper feeder:** 2 × 1,500 sheets, A4, 60–256 g/m<sup>2</sup>; A4, B5, Letter  
**PF-7120 Paper feeder:** 3,000 sheets, 60–256 g/m<sup>2</sup>; A4, B5  
**PF-7130 Multiside Tray:** 1 × 500 sheets  
**DF-7110 Document finisher:** Main tray: max. 4,000 sheets A4 (3,000 sheets with BF-730 attachment), max. 60–300 g/m<sup>2</sup>, max. B5R–305 × 457mm;  
Sub-tray: 200 sheets A4, 60–300 g/m<sup>2</sup>, A6R–305 × 457mm; Stapling up to 65 sheets A4  
**DF-7130 Document finisher:** Main tray: max. 4,000 sheets A4 (3,000 sheets with BF-9100 attachment), max. 52–300 g/m<sup>2</sup>, max. B5R–305 × 457mm; Sub-tray: 200 sheets A4; 52–300 g/m<sup>2</sup>, A6R–305 × 457mm, Stapling up to 100 sheets A4  
**PH-7C/PH-7D Punch unit:** for DF-7110/DF-7130  
**AT-730(B) 7-Bin Mailbox sorter:** for DF-7110  
**BF-730 for DF-7110 Booklet and tri-folding unit:** Half folding: 60–256 g/m<sup>2</sup>; A3, B4, A4R; Booklet: max. 16 sheets (64 pages, 60–90 g/m<sup>2</sup>); Non-staple folding: max. 5 sheets (60–90 g/m<sup>2</sup>); Tri-folding: 60–105 g/m<sup>2</sup>, A4R; Multi tri-folding: 5 sheets (60–90 g/m<sup>2</sup>)  
**BF-9100 for DF-7130 Booklet and tri-folding unit:** Half folding: 52–256 g/m<sup>2</sup>; A3, B4, A4R; Booklet: max. 20 sheets (80 pages, 60–90 g/m<sup>2</sup>); Non-staple folding: max. 5 sheets (60–90 g/m<sup>2</sup>); Tri-folding: 5 sheets (60–90 g/m<sup>2</sup>)  
**Copy tray (D):** upper tray 100 sheets, lower tray 250 sheets  
**USB IC Card Reader + Card Authentication Kit (B):** Supports various authentication card keys.  
**NK-7120:** Numeric keypad  
**Keyboard Holder 10**  
**UG-33:** ThinPrint support  
**UG-34:** Emulation (IBM Proprinter/EPSON LQ-850/Diablo 630)  
**Banner Guide (A):** Banner paper feeding guide up to 10 sheets  
**Optional interface:**  
**IB-35:** Direct Wi-Fi Interface  
**IB-50:** Gigabit Ethernet: 10BaseT/100BaseTX/1000BaseT (RJ45)  
**IB-51:** Wireless Lan (802.11b/g/n)

The TASKalfa 9003i incorporates extremely durable components that guarantee efficient and reliable operation, to meet the demanding requirements of busy office environments. The TASKalfa 9003i provides effective productivity and maximum flexibility whilst ensuring minimum impact on the environment. This product is compliant with Energy Star.



KYOCERA Document Solutions Partner

NOVEMBER2019DSTASKALFA9003I/VER1.0

KYOCERA Document Solutions South Africa  
90 Bekker Road, Hertford Office Park, Vorna Valley, Midrand  
Tel (011) 595 2600  
www.kyoceradocumentsolutions.co.za – info@dza.kyocera.com



kyoceradocumentsolutions.co.za